

Thrust ball bearings - Single direction - With spherical back face

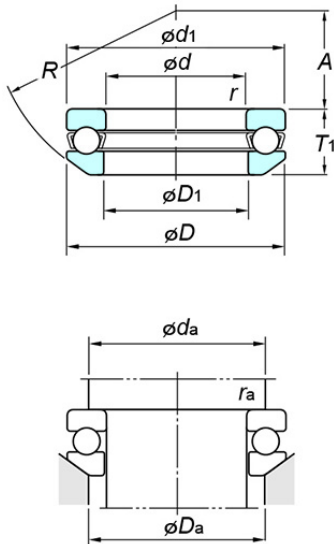

Bearing No. 53216

Specifications

(Boundary dimensions ...etc)

d(mm)	80
D(mm)	115
T(mm)	29.5
r(min.)(mm)	1
Basic load ratings Ca(kN)	98.1
Basic load ratings C0a(kN)	218
Fatigue load limit : Cu(kN)	9.85
Limiting speeds(Grease lub.)(min-1)	1700
Limiting speeds(Oil lub.)(min-1)	2600
d1(max.)(mm)	115
D1(min.)(mm)	82
D2(mm)	-
D3(mm)	-
A(mm)	46
R(mm)	90
C(mm)	-

Mounting dimensions

da(min.)(mm)	101
Da(max.)(mm)	94
ra(max.)(mm)	1

Refer.

(Refer.)Mass(kg)	0.930
------------------	-------